

Requires the installation of a :

Gateway module

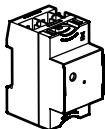

OR

Connected Starter Pack
"... with Netatmo"

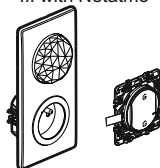

Composition

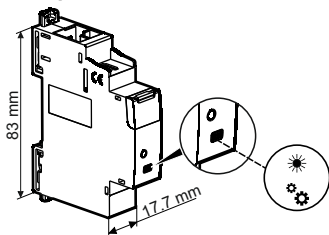

Connected energy meter

+

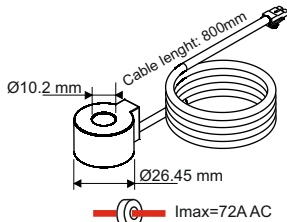

⚠ Pay attention to the direction of the current
Measure coil

| | U | I measure | F | Accuracy | Measure | CE Directive Compliant with the following European directive: |
|---------------|------------------------|---------------------|-------------------------------|--------------------|-------------|---|
| +5°C +45°C | 100-240V~ 50 / 60Hz | 72A MAX | 2.4 à 2,4835Ghz <100 mW | +/-1% under 63A | Global | Low voltage directive (LVD) 2014/35/UE Electromagnetic compatibility (CEM) n° 2014/30/UE |

Imperative security precaution



Failure to strictly comply with the installation and use conditions may result in risk of electric shock or fire.

1 Preparation, connexion

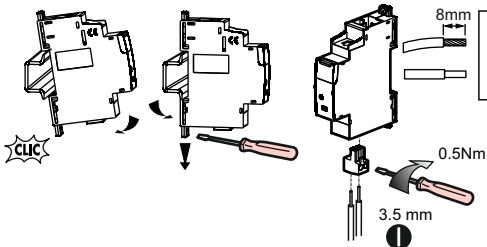
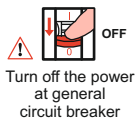

Wiring

In case of three Lines electrical installation, it is necessary to supply the product with the same Line as that measured

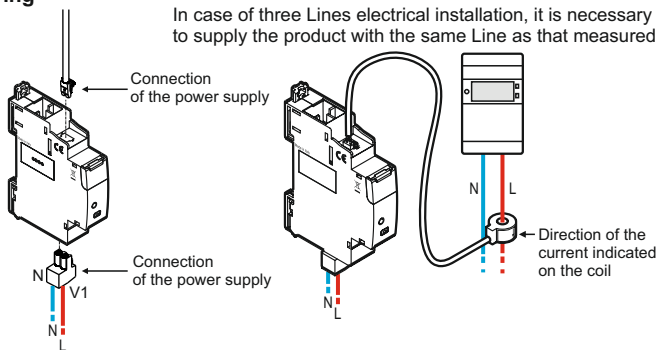

A circuit breaker for the Energy meter is necessary

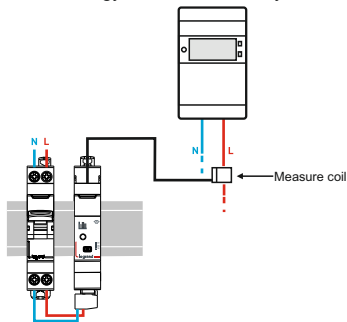

— N (neutral) = blue

— L (Line) = Everything but blue and green/yellow

2 Add the **Energy meter** in a connected installation

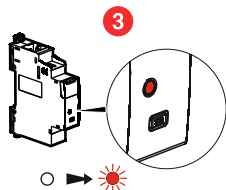
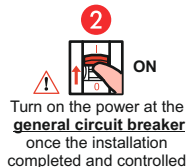
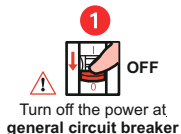

3 Press and hold the Gateway module settings button, or in the center of the General Scenario Wireless Command until the LED turns green, then release the button.

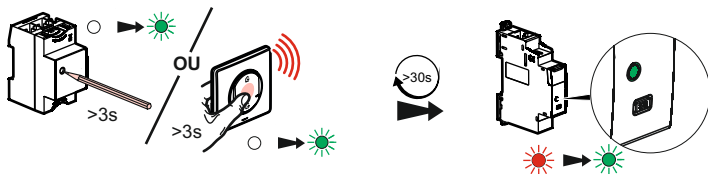

The configuration LEDs of " ... with Netatmo " devices must all light up in fixed green.

4 Complete the installation

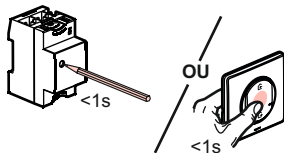

Briefly press the setting button on the Gateway module (or in the center of the General Scenario Wireless Command) to finalize the installation. All devices LED go OFF.

5 Finalize the installation in the Legrand Home + Control app

To add this connected product and peripheral items in your connected installation, you must follow the instructions:

- with Legrand Home + Control app

(Parameters/Add new product)

- or consult the guides and instructions sheets on **legrand.fr**



Reset an Energy meter to remove it from a connected installation

Press the button for more than 5 seconds
configuration of the Energy meter until
the configuration indicator lights up solid red.
It is no longer associated with the Gateway module
/ Control socket.

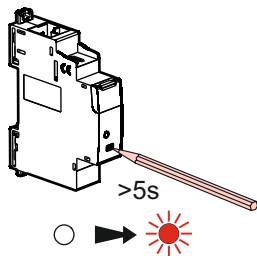

www.legrand.fr/reference/412015

LEGRAND - Pro and Consumer Service - BP 30076
87002 LIMOGES CEDEX FRANCE • www.legrand.com

EU SIMPLIFIED DECLARATION OF CONFORMITY

The undersigned,

Legrand

declares that the radio equipment listed on this instruction sheet
are compliant to the directive 2014/53/UE.

The full text of the EU declaration of conformity
is available at the following website:

www.legrandoc.com